

GN 5336

Lobe knobs

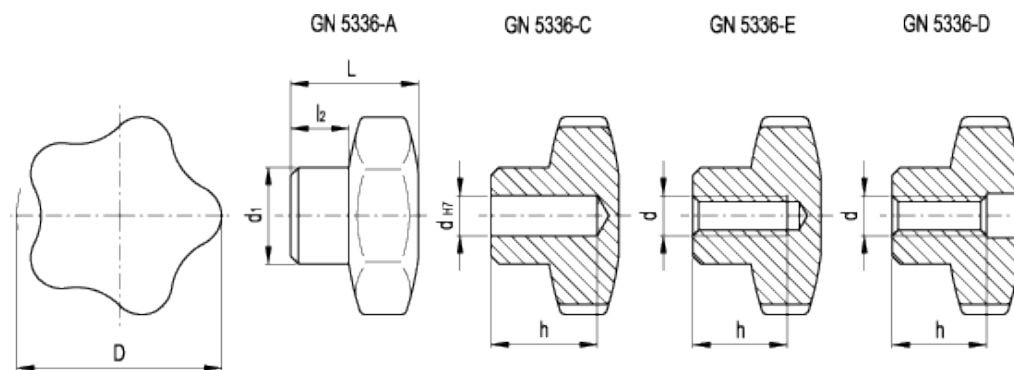

technical informations

Material

Cast aluminium.

- Execution PL: with deburred and mirror-polished finish.
- Execution MT: with sandblasted matte finish.

Assembly

- Execution A: hub not drilled, only with matte finish.
- Execution C: hub, H7 reamed blind hole.
- Execution E: hub, tapped blind hole.
- Execution D: hub, tapped through hole.

For fixing GN 5336 on shafts by a grub screw see [Technical Data](#).

Standard Elements	Main dimensions				Mounting hole			Weight
Description	D	L ₋₁	d _{1-0.5}	l ₂	d _{H7}	d	h	g
GN 5336-40-A-MT	40	26	14	12.5	-	-	-	31
GN 5336-40-B8-C-*	40	25	14	12.5	8	-	15	28
GN 5336-40-M6-E-*	40	25	14	12.5	-	M6	15	30
GN 5336-40-M8-D-*	40	25	14	12.5	-	M8	15	29
GN 5336-40-M8-E-*	40	25	14	12.5	-	M8	15	28

GN 5336-50-A-MT	50	33	19	16	-	-	-	57
GN 5336-50-B10-C-*	50	32	19	16	10	-	18	53
GN 5336-50-M8-E-*	50	32	19	16	-	M8	18	56
GN 5336-50-M10-D-*	50	32	19	16	-	M10	20	54
GN 5336-50-M10-E-*	50	32	19	16	-	M10	18	54
GN 5336-60-A-MT	60	41	21	20	-	-	-	101
GN 5336-60-B12-C-*	60	40	21	20	12	-	22	92
GN 5336-60-M10-E-*	60	40	21	20	-	M10	22	91
GN 5336-60-M12-D-*	60	40	21	20	-	M12	26	90
GN 5336-60-M12-E-*	60	40	21	20	-	M12	22	88
GN 5336-70-A-MT	70	47	26	23	-	-	-	163
GN 5336-70-B16-C-*	70	46	26	23	16	-	28	142
GN 5336-70-M12-E-*	70	46	26	23	-	M12	28	153
GN 5336-70-M16-D-*	70	46	26	23	-	M16	32	174
GN 5336-70-M16-E-*	70	46	26	23	-	M16	28	142

* Complete the description of the standard item needed by adding the index of the finish: MT (matte) or PL (polished).



ELESA and GANTER models all rights reserved in accordance with the law. Always mention the source when reproducing our drawings.

STANDARD MACHINE ELEMENTS WORLDWIDE